



## SERIES 40

### Non Progressive

SERIES 40 is an economically priced system with fast installation and eliminates the need for clips. Multiple options and numerous colors for recessed, caulked panel joints. Series 40 is an aluminum composite system with endless possibilities for color and texture.

#### ADVANTAGES:

Professional look with recessed, caulked joints

Allow for thermal movement of panels in all directions

Weather Tight  
Non Progressive

Available in several colors and textures

Conveyor Engineering  
Cedar Rapids, IA



**METAL  
DESIGN  
SYSTEMS**

DESIGNED FOR  
A PERFECT FIT.

4150 C Street SW | P.O. Box 1165

Cedar Rapids, IA | 52406-1165

319-362-7454 | Toll Free 866-442-6803

Fax 319-396-2935 | sales@crmdsi.com

**METALDESIGNSYSTEMS.COM**

**SERIES 40** NON-PROGRESSIVE



**METAL  
DESIGN  
SYSTEMS**

DESIGNED FOR  
A PERFECT FIT.

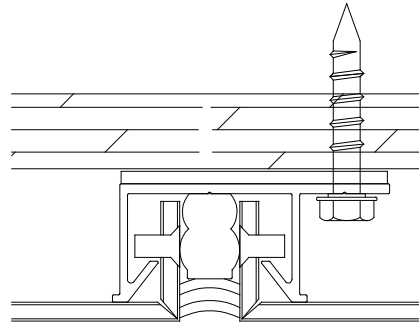
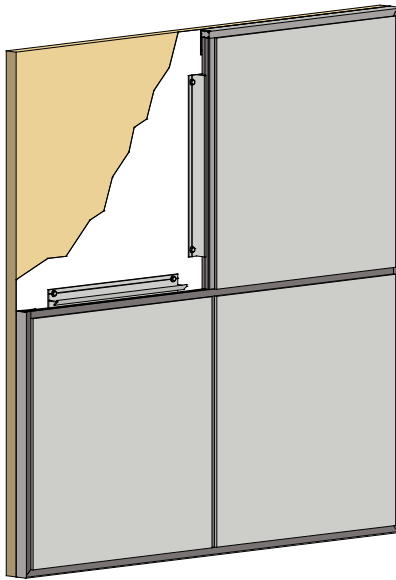

**SERIES 40** is easy to install due to the semi-continuous attachment extrusions and the innovative lock-in-place backer wedge. This system is available as a wet sealed caulk system. Since the Series 40 is a non-progressive system, any panel can be removed or replaced without removing adjacent panels, further adding to the desirability of this system. Series 40, when installed offers clean lines, optimizes panel to panel alignment, and allows for thermal movement.

**SERIES 40** System Features

System	Non-Progressive
Joint Type/Size	Caulked
Progressive System	Non-Progressive Installation
Underlayment	Tyvek Recommended
Sheathing Over Studs	Not required - 5/8" Plywood Preferred
Curved Surfaces	Excellent for Radius Applications
Independently Tested	ASTM E283, E331, E330 & AAMA 501
Maintenance Free	No
Allow for Thermal Expansion	Yes
Price	Medium Priced
Weather Sealed System	Yes
Ease of Installation	Easy